

TWO PARTS Lithium

By Christo Logan

Notes _____

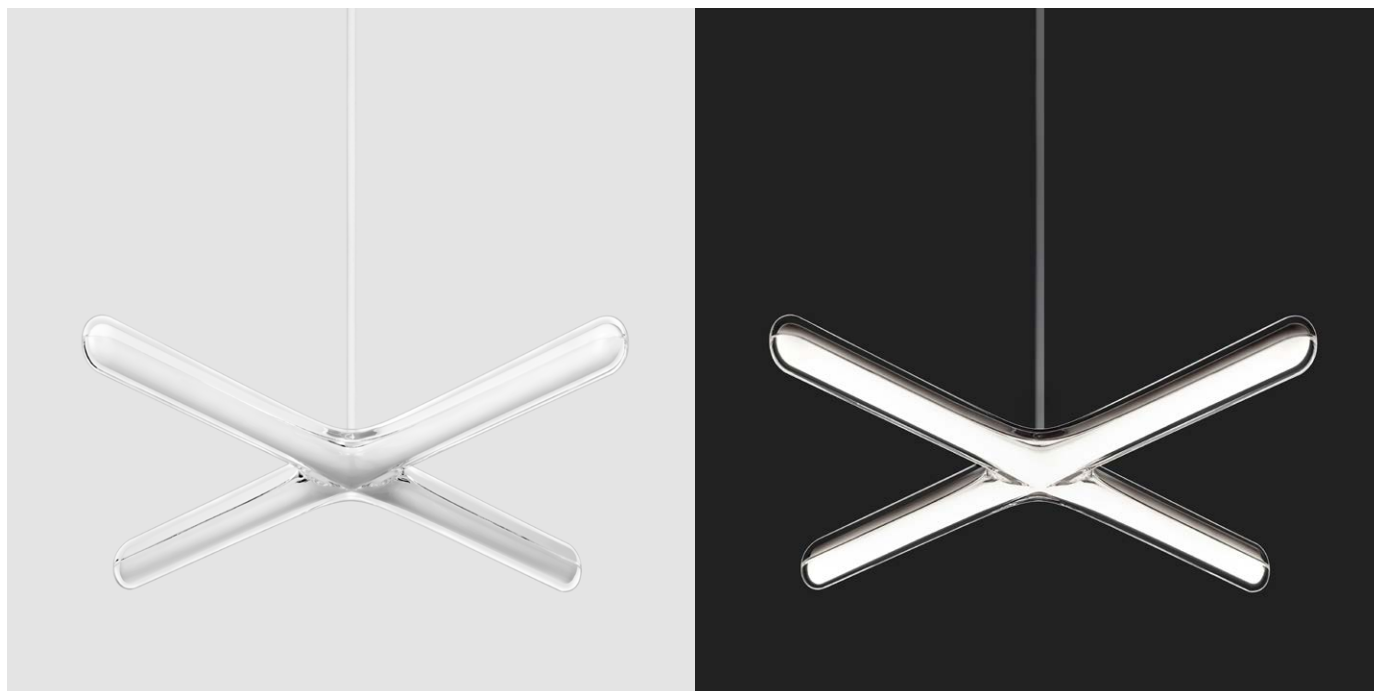

Description

Indoor Fixture: Direct
Material: Acrylic + Polycarbonate

Pendant

Flexible Cord Color: White
Max Cord Length: 20 ft / 6 m
Swag Hook: White
Rigid Stem (opt'l): 6" - 150"

Sconce

ADA compliant

LED

Power: 11W
Voltage: 12V DC CV
Output: 800 lm
User replaceable: No
Life Expectancy: 50,000 hours
Color Accuracy: CRI 95+, R9 90+

Warranty

Fixture: 5 years
Driver: 3 years

Certification (Pendant)

ETL Listed (UL + CSA Standards)
Damp Location
CE, RoHS

LIT - CW - - -
 1 2 3

1 : Light Temperature

27 : 2700K
30 : 3000K
35 : 3500K

2 : Mount Type

C : Canopy02 Single-port
M : Canopy01 Multi-port (3A)
R : Canopy02 + Rigid Stem (3B)
S : Sconce Mount01 (3C)

3A : Multi-port Cluster Size

1 : 25W Driver
2 : 40W Driver
3 : 40W Driver
4 : 90W Driver
5 : 90W Driver
6 : 90W Driver
7 : 120W Driver

3B : Rigid Stem Length (Inch)

6 - 150 in 6" increments

3C : Sconce Finish

W : White
B : Brushed Metal

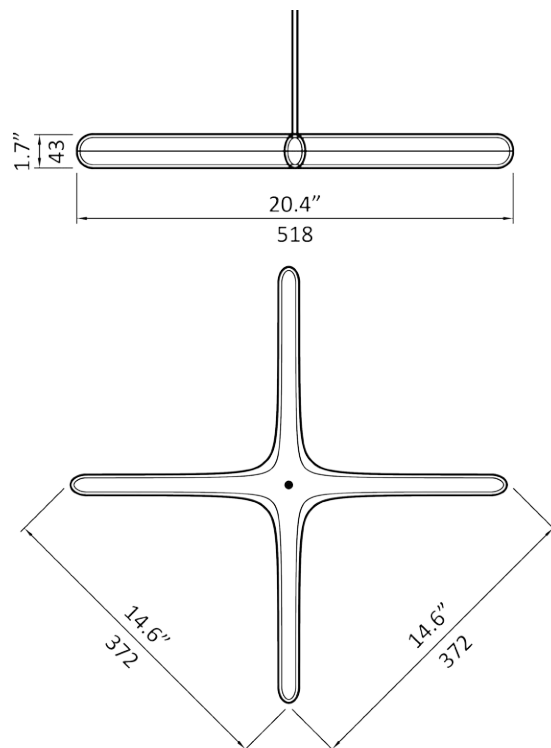

Download CAD, Revit, IES

<http://two.parts/lithium>

TWO PARTS Driver 10/25/40W

By LTF LLC

Notes _____

D10W12V-UI-UD

Power: 10W
Max Current: 833mA

Manufacturer Part

LTF DS10W12VMB1UD

Dimensions

2.7 x 1.6 x 0.9 in
68 x 40 x 22 mm

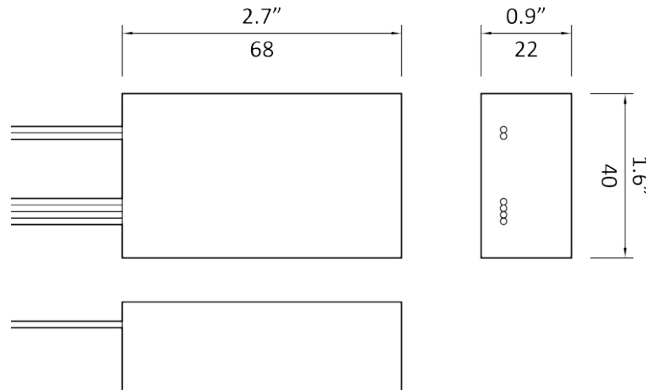

Description

Dimmable Low Voltage LED Driver

Features

Fits in most Junction Boxes
Auto-reset, Short Circuit,
Overload and Thermal
Protection

Warranty

3 year limited warranty

Input

Voltage: 100-305V AC
Frequency: 50/60Hz

Output

Type: Constant Voltage
Voltage: 12V DC

Specs

Dimming: Triac, ELV, 0-10V
Class: Class 2 Power Supply
IP Rating: IP67
Humidity: 95% RH Max

Certification

UL8750, UL1310
CE, RoHS
FCC Part 15 Class B
Compliant

D25W12V-UI-UD

Power: 25W
Max Current: 2083mA

Manufacturer Part

LTF DS25W12VBF1UD

Dimensions

3.1 x 1.5 x 1.0 in
78 x 38 x 26 mm

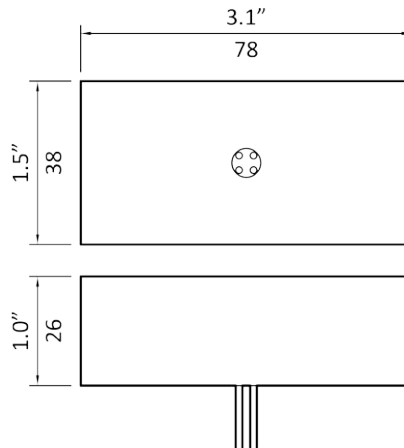

D40W12V-UI-UD

Power: 40W
Max Current: 3333mA

Manufacturer Part

LTF DS40W12VOCUD

Dimensions

3.5 x 2.5 x 1.2 in
90 x 63 x 30 mm

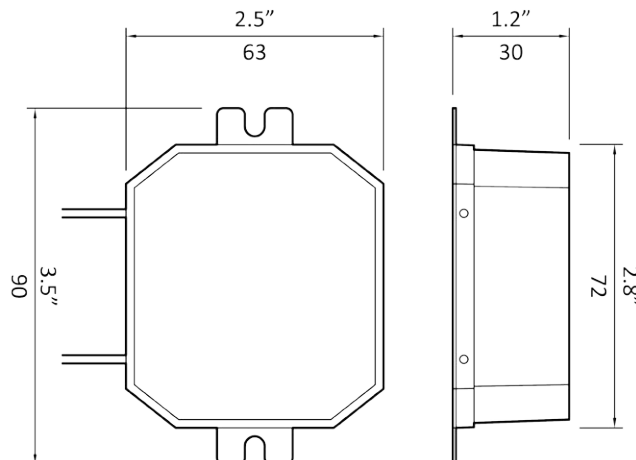

TWO PARTS Driver 90/120/200W

By Mean Well

PWM-90-12

Power: 90W

Max Current: 7.5A

Manufacturer Part

Mean Well PWM-200-12

Dimensions

6.8 x 2.5 x 1.5 in

171 x 63 x 37.5 mm

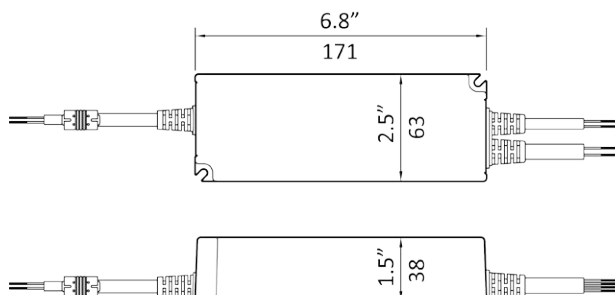

Description

Dimmable Low Voltage LED Driver

Features

Protections: short circuit, over load, over voltage, over temperature

Warranty

3 year limited warranty

Input

Voltage: 100-305V AC

Frequency: 50/60Hz

Output

Type: Constant Voltage

Voltage: 12V DC

Specs

Dimming: 0-10V, 10V PWM

IP Rating: IP67

Humidity: 95% RH Max

Certification

UL8750

CSA C22.2 No. 250.13-12

PWM-120-12

Power: 120W

Max Current: 2083mA

Manufacturer Part

Mean Well PWM-200-12

Dimensions

3.1 x 1.5 x 1.0 in

78 x 38 x 26 mm

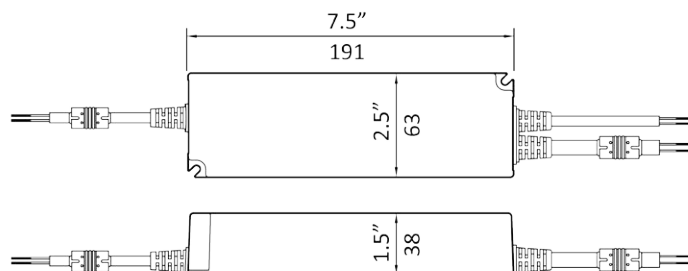

PWM-200-12

Power: 200W

Max Current: 3333mA

Manufacturer Part

Mean Well PWM-200-12

Dimensions

3.5 x 2.5 x 1.2 in

90 x 63 x 30 mm

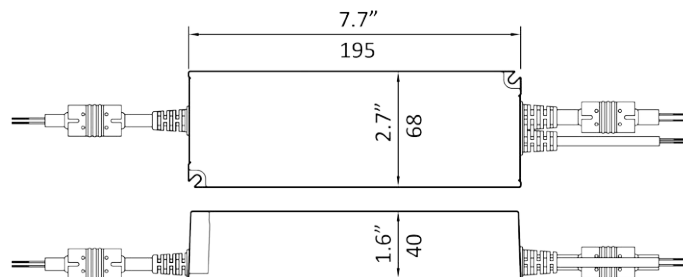

TWO PARTS

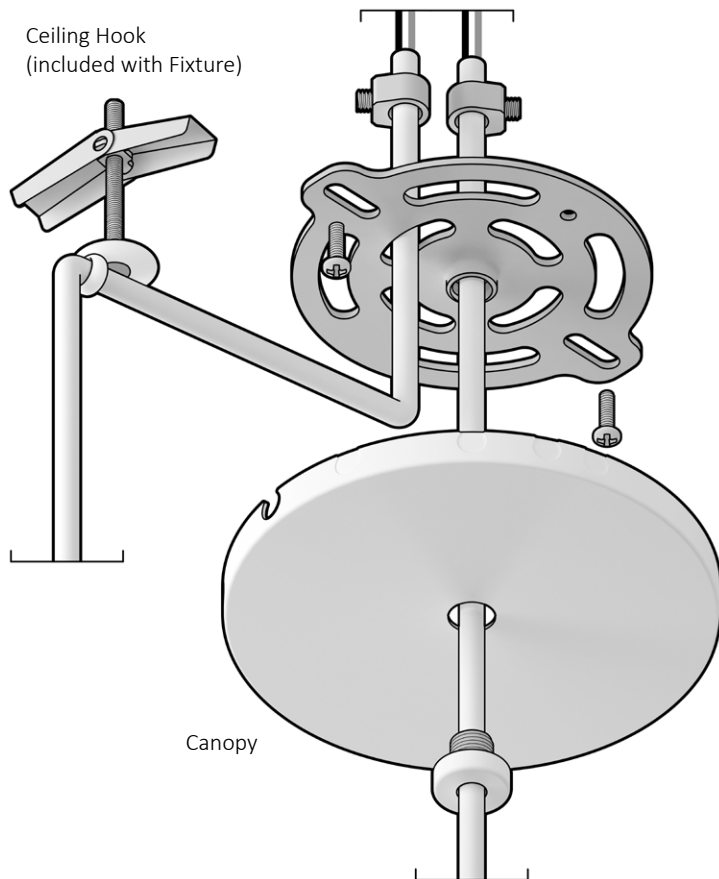

Canopy01 Multi-port Canopy

By Christo Logan

Part No

C01-W-7P

Canopy

Fixtures Supported: 1- 7

Material: Steel

Color: White

Dims: Ø4 1/2 x H3/8 in

Dims: Ø115 x H9 mm

Features

Low Profile

No exposed screws

Side port knockouts

Center port cap

Ceiling Hook

Included with Fixture

Screw size: #8 or M4 flathead

Material: Steel

Color: White

Dims: Ø0.8 x H0.4 in

Dims: Ø20 x H11 mm

Certification

ETL Listed (UL & CSA Standards)

Damp Location

CE, RoHS

Download CAD, Revit

<http://two.parts/canopy01>

Center & Side Mounted



1

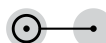

2



3

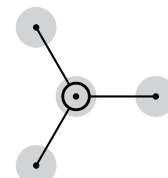

4

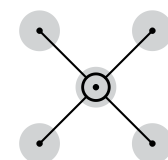

5

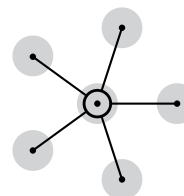

6

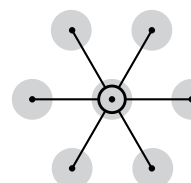

7 Fixtures

Side Mounted Only

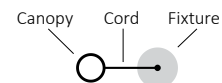

1

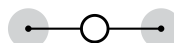

2

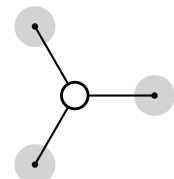

3

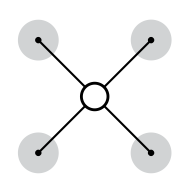

4

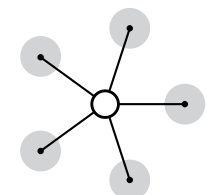

5

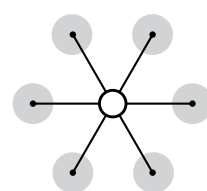

6

7 Fixtures

TWO PARTS

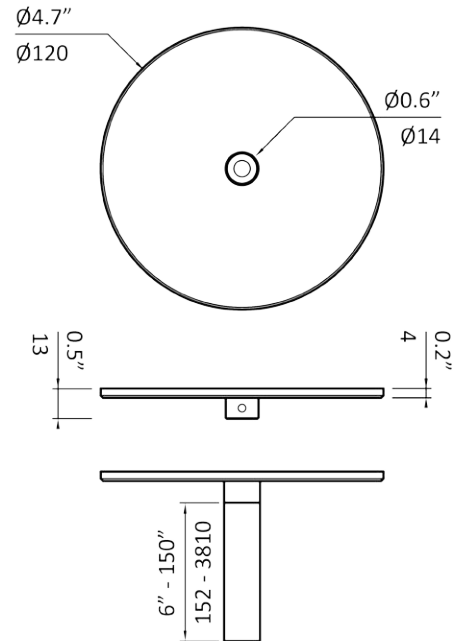
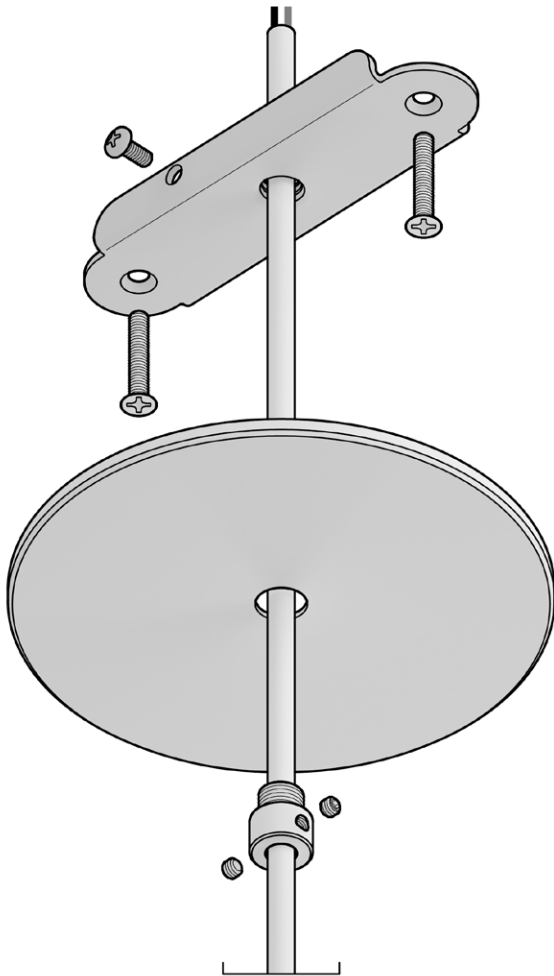

Canopy02 Single-port Canopy

By Christo Logan

Part No

C02-W-1P

Canopy

Fixtures Supported: 1

Material: Aluminum

Color: White

Dims: $\varnothing 4 \frac{1}{2} \times H3/8$ in

Dims: $\varnothing 115 \times H9$ mm

Features

Low Profile

RigidStem02 optional

Certification

ETL Listed (UL & CSA Standards)

Damp Location

CE, RoHS

Download CAD, Revit

<http://two.parts/canopy02>

RigidStem02

By Christo Logan

Part No

RS02

Canopy

Fixtures Supported: 1

Material: Aluminum

Color: White

Diameter: 0.6 in / 16 mm

Length: 6" - 150" in 6" increments

Features

Low Profile

No exposed screws

TWO PARTS



Sconce Mount01

By Christo Logan

Part No

M01-B / M01-W

Surface Mount

Fixtures Supported: 1

Material: Aluminum

Colors: Matte White, Brushed Metal

Dims: Ø4.5 x H1.3 in

Dims: Ø120 x H34 mm

Features

Low Profile

Download CAD, Revit

<http://two.parts/mount01>

Compatibility

ADA: Calcium, Carbon, Lithium

Non-ADA: Helium, Hydrogen

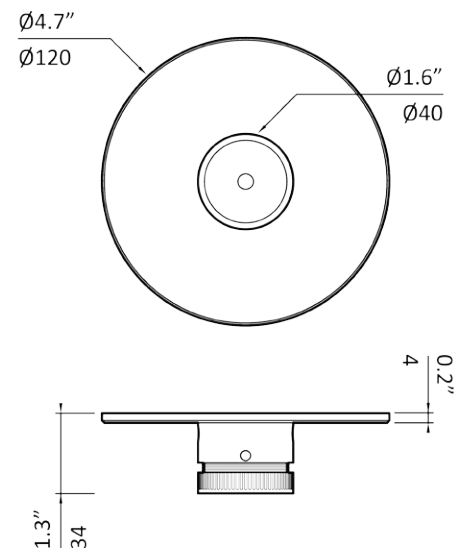

TWO PARTS

Circuit Connector
(customer provided)
Must be UL/CSA/CE approved (US/Canada/
Europe) for applicable wire gauge

LED Driver
To be housed in accessible location
as near as possible to Fixture.

Circuit Connector
(customer provided)
Must be UL/CSA/CE approved
(US/Canada/Europe) for
applicable wire gauge

Anchor
Hole Ø: 9/16" or 15mm

Ceiling Hook
Use #8 or M4 flathead
screw located ½" or
13mm shy of fixture
location

Cord
Side Mounted

Side Port Knockout

Building Wires
(customer provided)

Internal Wires
Black+ White-
Multiple Fixtures to be wired
in parallel to a single Driver

Cord Grip
Tighten screw to
ensure cord cannot
move

Ground Screw
Tighten around
Ground Wire

Screw
(customer provided)

Canopy

Center Port

Canopy Screw

Cord
Center Mounted

CANOPY01 INSTALL GUIDE

All components are included
unless otherwise noted.

WARNING

Electric shock risk. Use caution
when installing. Turn off
electrical power at breaker
before installation. Installation
should be performed by a
qualified electrician only.

The installer must ensure that
the ceiling can support fixture's
weight and reinforce ceiling
structure by adequate means if
necessary.

MAINTENANCE

Wipe exposed surfaces with
dry cloth as needed.

INSTRUCTIONS

1A Center Mount Remove cap
from Canopy Screw.

1B Side Mount Install Ceiling
Hook(s) with loop facing away
from canopy. Knock out side
port(s) according to cluster
configuration.

2 Cut each Cord to desired
length, leaving 3" (70mm) of
exposed Internal Wires.

3A Center Mount Thread
Cord through Canopy Screw,
Canopy, Crossbar and Cord
Grip.

3B Side Mount Thread Cord
through Ceiling Hook, Crossbar
and Cord Grip.

4 Secure Cord Grip onto each
Cord with 1/2" (10mm) of Cord
left above.

5 Using Circuit Connectors
appropriate to local building
code, connect Internal Wires
to Driver and connect Driver to
Building Wires.

6 Screw Crossbar to ceiling or
outlet box.

7 Affix Canopy Screw to
Crossbar with Canopy in
between.

TWO PARTS

Circuit Connector
(customer provided)
Must be UL/CSA/CE approved (US/Canada/
Europe) for applicable wire gauge

LED Driver
To be housed in accessible location
as near as possible to Fixture.

Circuit Connector
(customer provided)
Must be UL/CSA/CE approved
(US/Canada/Europe) for
applicable wire gauge

Ground Screw
Tighten around Ground Wire

Building Wires
(customer provided)

Internal Wires
Black+ White-

Crossbar

Flathead Screw

Canopy Cover

Set Screw

Canopy Screw

Cord
Center Mounted

CANOPY02 INSTALL GUIDE

All components are included
unless otherwise noted.

WARNING

Electric shock risk. Use
caution when installing. Turn
off electrical power at breaker
before installation. Installation
should be performed by a
qualified electrician only.

The installer must ensure
that the ceiling can support
fixture's weight and reinforce
ceiling structure by adequate
means if necessary.

MAINTENANCE

Wipe exposed surfaces with
dry cloth as needed.

INSTRUCTIONS

1 Cut Cord to desired
length, leaving 3" (70mm)
of exposed Internal Wires.

2 Thread Cord through
Canopy Screw, Canopy
Cover, and Crossbar.

3 Using code-compliant
Circuit Connectors, connect
Internal Wires to Driver and
Driver to Building Wires.

4 Screw Crossbar to ceiling
or outlet box.

5 Affix Canopy Screw
to Crossbar with
Canopy Cover in
between.

6 Tighten both Set
Screws on Cord.

TWO PARTS

MOUNT01 INSTALL GUIDE

All components drawn are included unless otherwise noted.

WARNING

Electric shock risk. Use caution when installing. Turn off electrical power at breaker before installation. Installation should be performed by a qualified electrician only.

The installer must ensure that the ceiling can support fixture's weight and reinforce ceiling structure by adequate means if necessary.

MAINTENANCE

Wipe exposed surfaces with dry cloth as needed.

INSTRUCTIONS

- 1 Cut Cord to 4" (100mm) in length and strip 2" (50mm) of white cord cover to expose Internal Wires.
- 2 Tighten Standoff Ring, insert Cord into Standoff, and push Standoff Ring fully against Light Fixture.
- 3 While pulling Cord taut, tighten two Setscrews using included Allen Key.

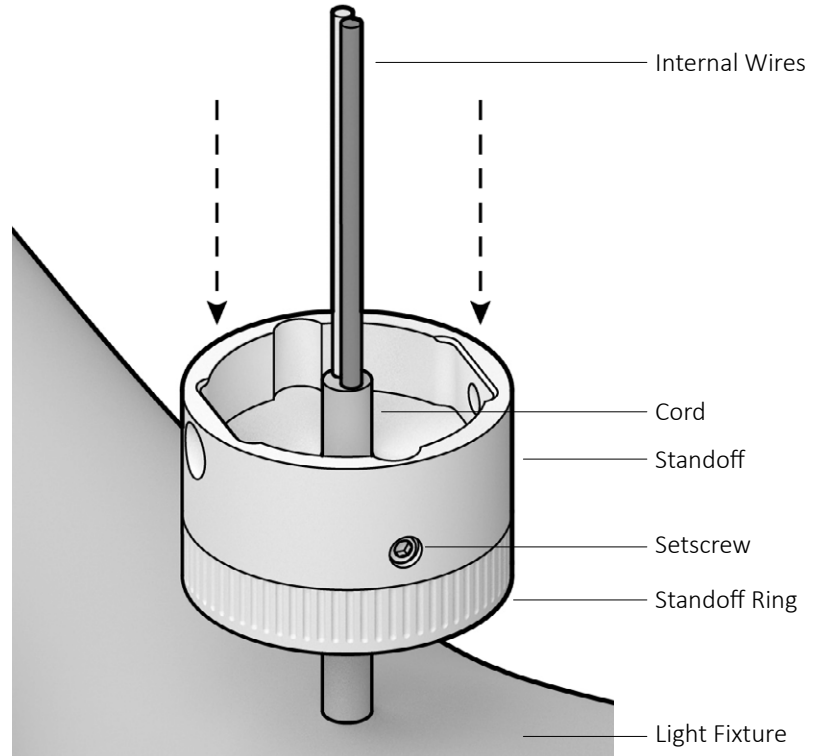

- 4 Using Circuit Connectors appropriate to local building code, connect Driver Wires to Building Wires.
- 5 Screw Crossbar to outlet box or wall.
- 6 Place Cover Plate over Crossbar and pull Driver Wires through center opening.
- 7 Using Circuit Connectors appropriate to local building code, connect Internal Wires to Driver Wires.
- 8 Screw Standoff to Crossbar Tabs.
- 9 Hold Standoff and turn Standoff Ring counter-clockwise to tighten against Light Fixture.

